

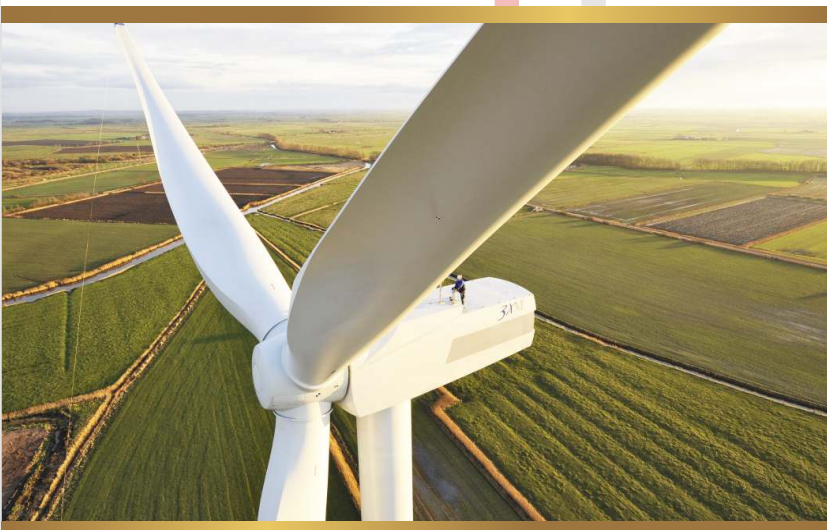

Wrapped Rectangular Copper Winding Wire

www.kshinternational.com

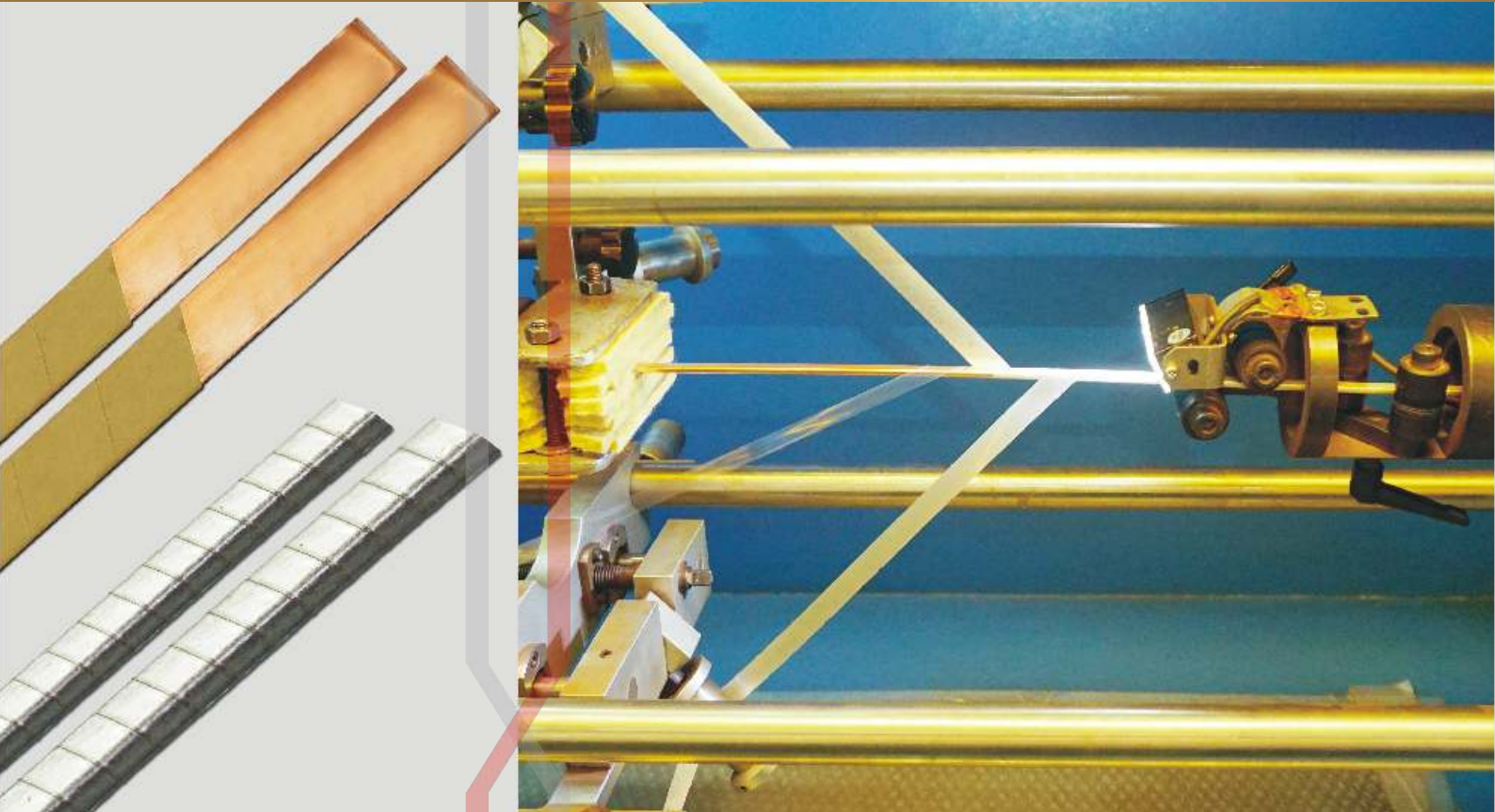

Typical Applications

- ✕ Oil Filled Power & Distribution Transformers
- ✕ High Voltage Motors/Generators
- ✕ 765 Kv Transformers and Reactors
- ✕ 1200 Kv Transformers
- ✕ Traction Transformers
- ✕ Dry Type Transformers
- ✕ Resin Cast Transformers
- ✕ Wind Mill Generators

Wrapping Method

- X Butt Wound Wrapping
- X Conventional Overlapped Wrapping
- X Multiple layers (Upto 32 layers on a single line)
- X Interlocked wrapping
- X Combinations

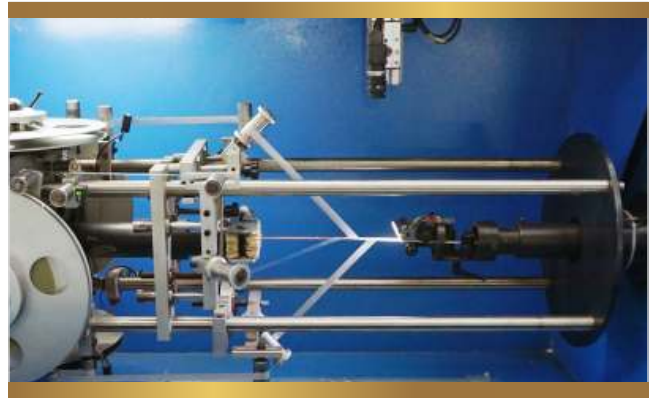

Build Criteria

0.3 – 6 mm Diametrical
Subject to insulation & Covering options

Reference Specifications

IEC, DIN, IS, other relevant National/
International/Customized standards

Insulation Options

- X Polyester Tape
- X Thermokraft Paper, Standard Density
- X Thermokraft Paper, Thermally Upgraded Paper
- X Nomex®
- X Mica Tape
- X High Density Micro-crepe Paper

Size Range		
Specifications	Minimum	Maximum
Width	3 mm (0.118in)	25 mm (0.985 in)
Thickness	0.8 mm (0.0315 in)	8 mm (0.315 in)
Cross Sectional Area	3.2 mm ²	200 mm ²

Normal Cross Section Areas Of Preferred Sizes

		Thickness																					
		mm	0.80	0.90	1.00	1.12	1.25	1.40	1.50	1.60	1.80	2.00	2.24	2.50	2.80	3.15	3.55	4.00	4.50	5.00	5.60	7.00	8.80
		in	0.031	0.035	0.039	0.044	0.049	0.055	0.059	0.063	0.071	0.079	0.088	0.098	0.110	0.124	0.140	0.157	0.177	0.197	0.220	0.276	0.346
Width	mm	in																					
	2.00	0.79																					
	2.24	0.088																					
	2.50	0.098																					
	3.15	0.124																					
	3.55	0.140																					
	4.00	0.157																					
	4.50	0.177																					
	5.00	0.197																					
	5.60	0.220																					
	6.30	0.248																					
	7.10	0.280																					
	8.00	0.315																					
	9.00	0.354																					
	10.00	0.394																					
	11.20	0.441																					
12.50	0.492																						
14.00	0.551																						
16.00	0.630																						
18.00	0.709																						
20.00	0.787																						
23.00	0.906																						
25.00	0.984																						
			R = 0.5 mm (0.0197 in)						R = 0.65 mm (0.0256 in)				R = 0.80 mm (0.0315 in)				R = 1.0 mm (0.0394 in)						

Packaging Details

Sr. No.	Flange Diameter D1 (mm)	Traverse Width B2 (mm)	Barrel Diameter D2 (mm)	Flange Thickness T (mm)	Overall Width B1 (mm)	Bore Diameter D3 (mm)	Capacity in Kgs
1	460 ± 10	230 ± 5	270 ± 5	20 ± 3	270	45 -0/+1	90
2	510 ± 10	250 ± 5	270 ± 5	22 ± 3	294	45 -0/+1	160
3	560 ± 10	250 ± 5	270 ± 5	22 ± 3	294	45 -0/+1	190
4	760 ± 10	330 ± 5	560 ± 5	30 ± 3	390	45 -0/+1	260
5	860 ± 10	330 ± 5	600 ± 5	30 ± 3	390	45 -0/+1	350
6	1015 ± 10	350 ± 5	700 ± 5	35 ± 3	420	45 -0/+1	450

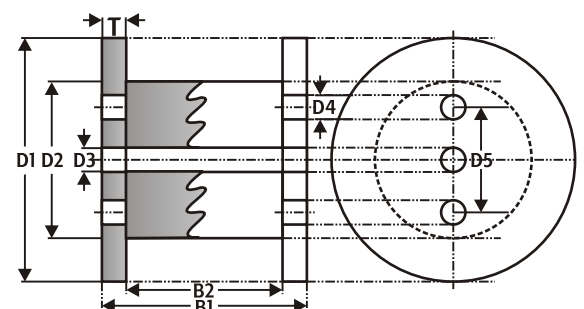

** Drum sizes shown are as per KSH standard. Other sizes as per requirement can be provided.